



X-GUN



C-GUN



## SPOT WELDING GUNS WITH BUILT-IN TRANSFORMER

The X-Gun and C-Gun series pneumatic operated suspended guns, versatile, robust and easy-to-use, ensure best welding results on any weldable metal and are the most ideal solution for any spotwelding job.

- ▶ Welding control in a separate cabinet with circuit breaker with residual current device and cycle stop emergency button
- ▶ Synchronous ignition SCR group with phase shift welding current adjustment to eliminate initial transient
- ▶ Reduced consumption
- ▶ Water cooled transformer
- ▶ Water cooled arms, electrode holders and electrodes
- ▶ Gyroscope suspension on sealed bearings for easy gun rotation and manoeuvrability in any position
- ▶ Adjustable working stroke
- ▶ Temporary extra stroke to easily reach workpiece areas also getting over obstacles
- ▶ High versatility in all applications thanks to all possible configurations
- ▶ Self-lubricated pneumatic components to eliminate oil deposits and to safeguard the environment from contaminants

### C-GUN

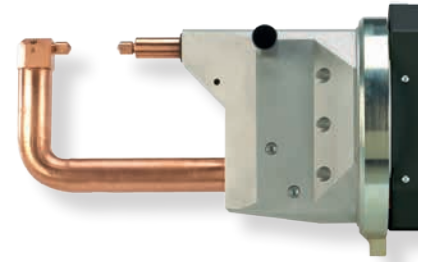
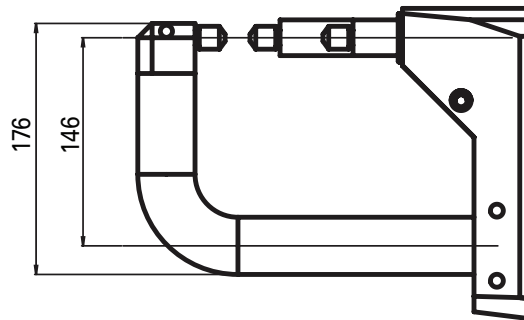

### X-GUN

Both straight (version 1) and angled (version 2) arms are available in a large variety and different lengths from 200 up to 600 mm.

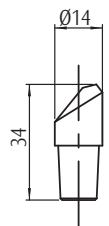
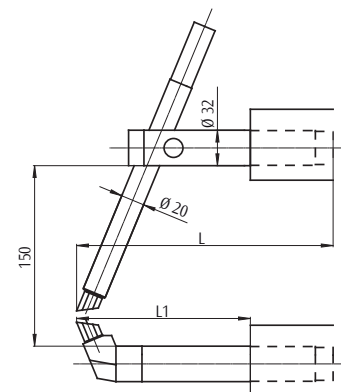
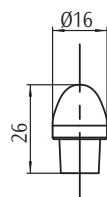
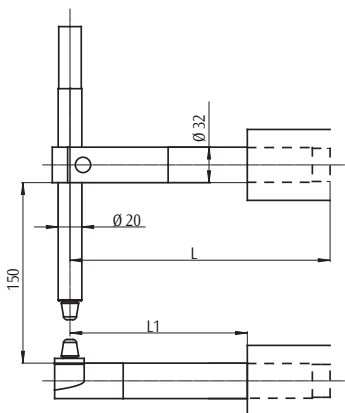
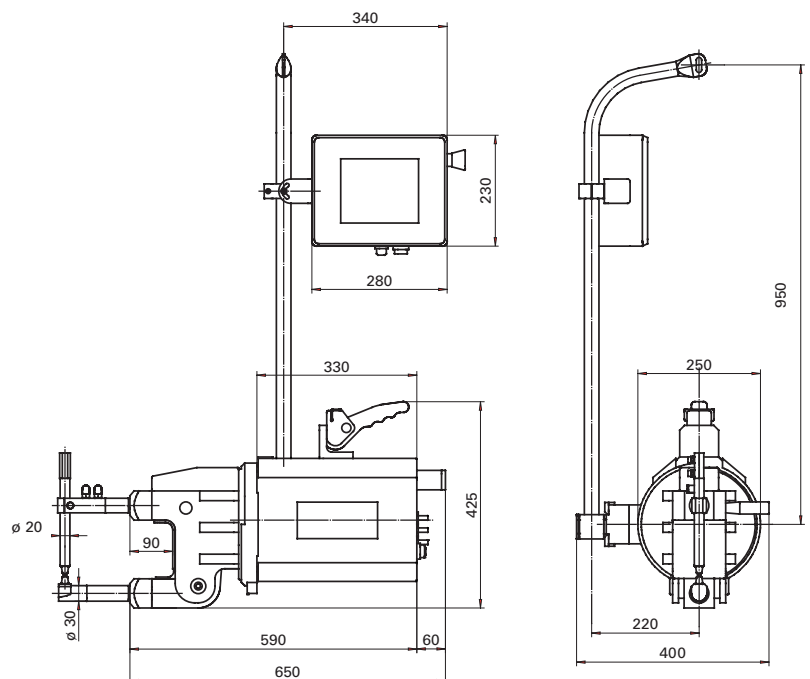

X-GUN VERSION 1					
L (mm)	220	300	400	500	600
L1 (mm)	155	235	335	435	535
(1) F (daN)	230	170	135	110	95
(2) P (kg)	2,7	3,5	4,6	5,7	6,7
(3) Cs (mm)	0-24	0-30	0-38	0-46	0-55
(4) Cl (mm)	57	73	93	112	131

1. Electrode force at 600 kPa (6bar)
2. Arm set weight
3. Welding stroke
4. Temporary extra stroke

X-GUN VERSION 2					
L (mm)	220	300	400	500	600
L1 (mm)	155	235	335	435	535
(1) F (daN)	230	170	135	110	95
(2) P (kg)	2,7	3,5	4,6	5,7	6,7
(3) Cs (mm)	0-24	0-30	0-38	0-46	0-55
(4) Cl (mm)	57	73	93	112	131

**FORCE - SHORT CIRCUIT CURRENT**

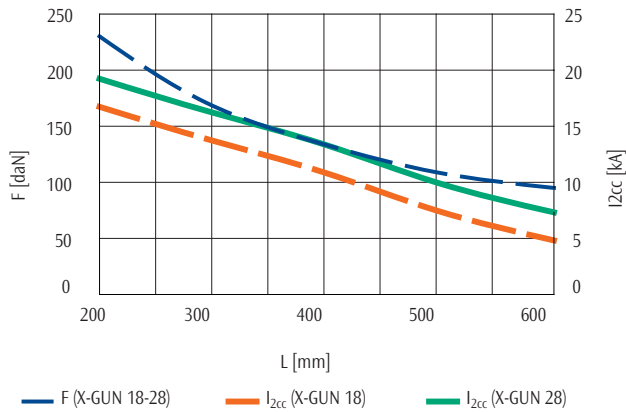

**WELDING CAPACITY (MILD STEEL)**

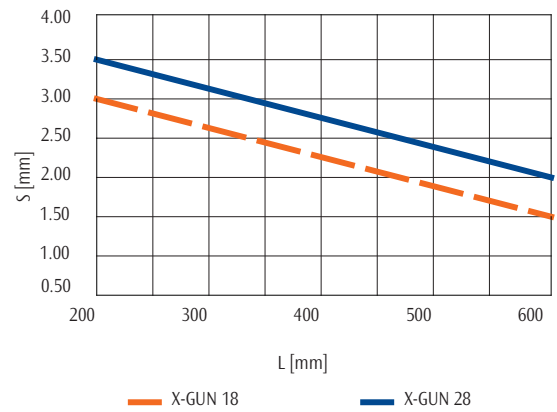

**X-GUN ELECTRODES**

**Standard**

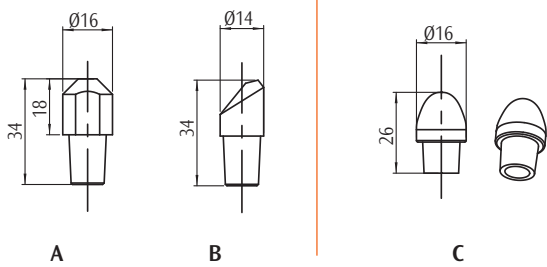

**Special**

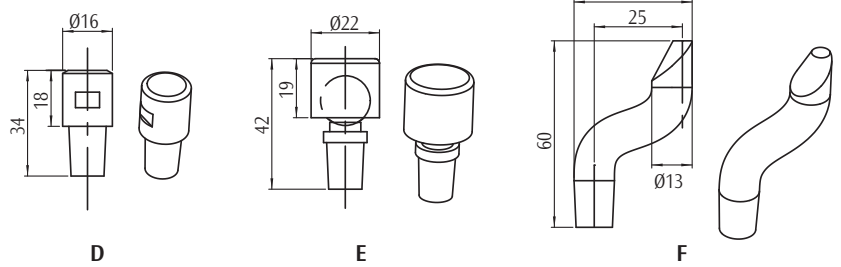

**X-GUN SPECIAL VERSIONS**

Version 3

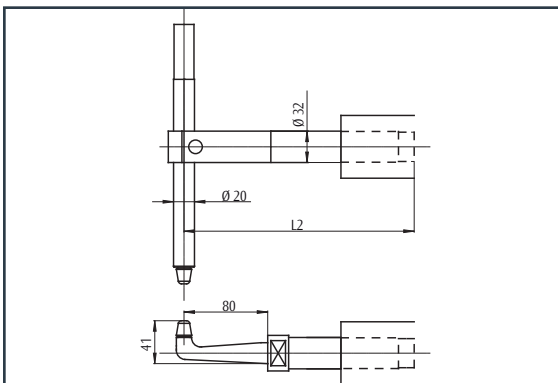

Version 4

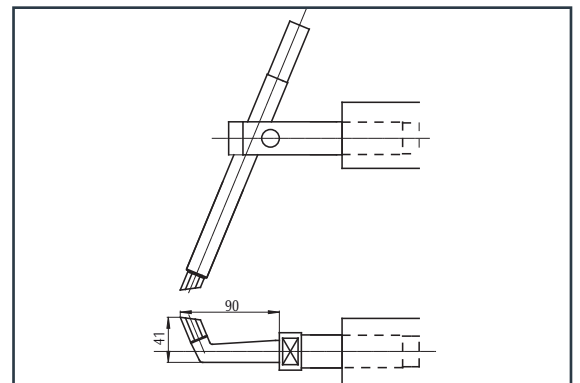

Version 5

Suitable for rod welding in building industry (8mm Ø max.)

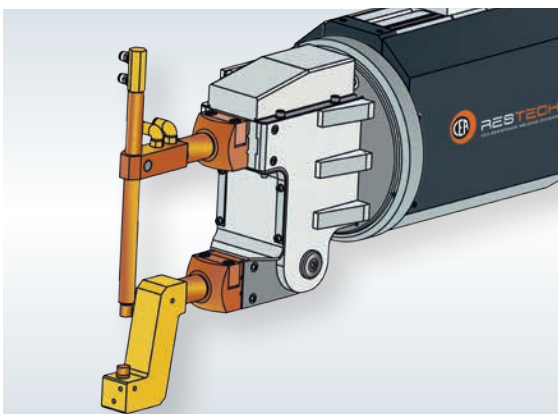

Version 6

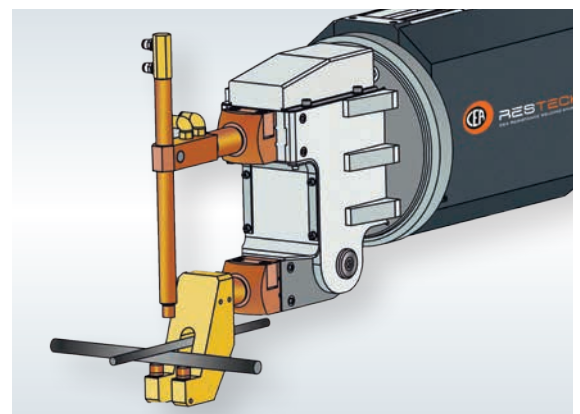

## WS 708 WELDING CONTROL

- ▶ Half period welding time
- ▶ Single or multi spot
- ▶ Mains voltage automatic compensation
- ▶ 2 programs retrievable from the handle switch selector
- ▶ 8 programs to be activated and used from the control keyboard
- ▶ Error messages
- ▶ Weld/no weld switch
- ▶ 24 V DC solenoid valve
- ▶ 50/60 Hz frequency automatic recognition
- ▶ 24 V AC mains supply for the control

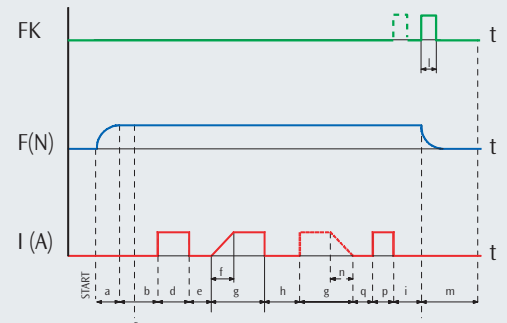
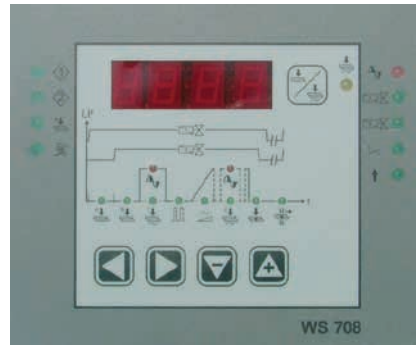

FUNCTIONS		WS 708
a	Pre-squeeze time	•
b	Squeeze time	•
c	Pressure contact	•
d	Preheating time	•
e	Cooling time	•
f	Slope up time	•
g	Welding time	•
	Welding current	•
h	Pulse interval time	•
i	Holding time	•
l	Cycle end contact	•
m	Pause time	•

TECHNICAL DATA		X-GUN		C-GUN
		18	28	28
Single phase input 50/60 Hz	V	400	400	400
Rated power at 50%	kVA	18	28	28
Max. welding power	kVA	58	88	98
Installed power	kVA	15	25	25
Delayed fuse	A	32	40	40
Open Circuit Voltage	V	4,8	5,8	5,8
Short circuit current	kA	15	19	21
Max. welding current	kA	12	15,2	16,8
Work stroke	mm	50	50	50 + 20
Max. electrode force (6 bar)	daN	230	230	300
Water consumption at 300 kPa (3 bar)	l/min	4	4	4
Dimensions	↗ mm	650	650	800
	→ mm	250	250	250
	↑ mm	425	425	425
Weight	kg	47	53	58

Other voltages on request.

Technical features might change without notice.



### ACCESSORIES

- ▶ Gun spring balancer
- ▶ Reducer with filter and manometer